



Prestige White Meadows

By Prestige Group

Whitefield Main Road



Scan Here
To get more details

Location

Located On Whitefield Main Road, Sathya Sai Layout, Whitefield, providing easy access to Work and Social infrastructure.

6 minutes from leading international schools

15 minutes away from **International Tech Park Bangalore**

Lavish Living Homes



About project

Prestige White Meadows is a premium residential enclave in Whitefield, Bengaluru, epitomizing luxury living amidst serene surroundings. Developed by the renowned Prestige Group, this ready-to-move-in community offers an exclusive collection of Sky Villas and Independent Bungalows.

Designed for discerning homeowners, Prestige White Meadows provides an elegant and sophisticated lifestyle.

Prestige White Meadows features 61 independent bungalows in 4 and 5.5 BHK configurations, ranging from 4,041 to 12,066 square feet. Each luxury villa in Whitefield is designed with spacious living areas, private gardens, and exclusive amenities to offer a lavish lifestyle.



Masterplan

Lavish Living
Homes

The modern clubhouse offers world-class amenities, including a gym, pool, spa, and entertainment lounge, in a luxurious villa & apartment community.

- **Location:** Whitefield Main Road, Sathya Sai Layout, Whitefield, Bengaluru.
- **Total Area:** 28.5 Acres.
- **Number of Villas:** 288 Sky Villas
- **61 Bungalows**
- **Villa Sizes:** 5800 sq.ft. to 6219 sq.ft.
- **Starting Price:** ₹11 Cr onwards.*
- **Possession:** Ready To Move
- **Approval :** BBMP



Every villa at Prestige White Meadows is a masterpiece of design.

A sprawling 70,000 sq. ft. clubhouse with a fully equipped gymnasium, spa, sauna, steam room, and health club.

- Sky Villa Grandeur: Triplex sky villas with private terraces redefine luxury living.
- Green Serenity: Over 75% open spaces with lush greenery ensure tranquility.
- The design prioritizes natural light and ventilation, enhancing the luxurious ambiance.
- Situated in the upscale locality of Whitefield, Prestige White Meadows offers excellent connectivity and proximity to key services



Snowdrop Bungalow Type A

4 BHK Villas

Built Up: 6129 Square Feet
Plot : 5500 Square feet

Snowdrop (Bungalow Type A)



First Floor Plan

Snowdrop (Bungalow Type A)



Second Floor Plan



Snowdrop (Bungalow Type A)



VILLA-A: 49 NOS.
PLOT NOS: 01,02,03,04,05,06,07,08,09,12,13,14,15,16,17,18,19,20,21,22,23,24,25,26,27,28,29,30,31,32,33,34,35,36,37,38,39,40,41,42,43,44,45,46,47,48,49,50,51,52,53,54,55,56,57,58,59,60,61,62,63,64,65 & 66.

TOWER 3

Cluster Plan: Level 26
(Duplex Sky Villas Unit-Lower Level Plan)

COLOUR	UNIT TYPE	NO.OF UNITS	SALEABLE AREA	CARPET+ BALCONY AREA
	A2 - SKY VILLAS	2	7737 SFT	6099 SFT
	B2 - SKY VILLAS	2	7788 SFT	6150 SFT



KEY PLAN



CLUSTER PLAN
TOWER-03

TOWER 3

Cluster Plan: Level 27
(Duplex Sky Villas Unit-Upper Level Plan)

COLOUR	UNIT TYPE	NO.OF UNITS	SALEABLE AREA	CARPET+ BALCONY AREA
	A2 - SKY VILLAS	2	7737 SFT	6099 SFT
	B2 - SKY VILLAS	2	7788 SFT	6150 SFT

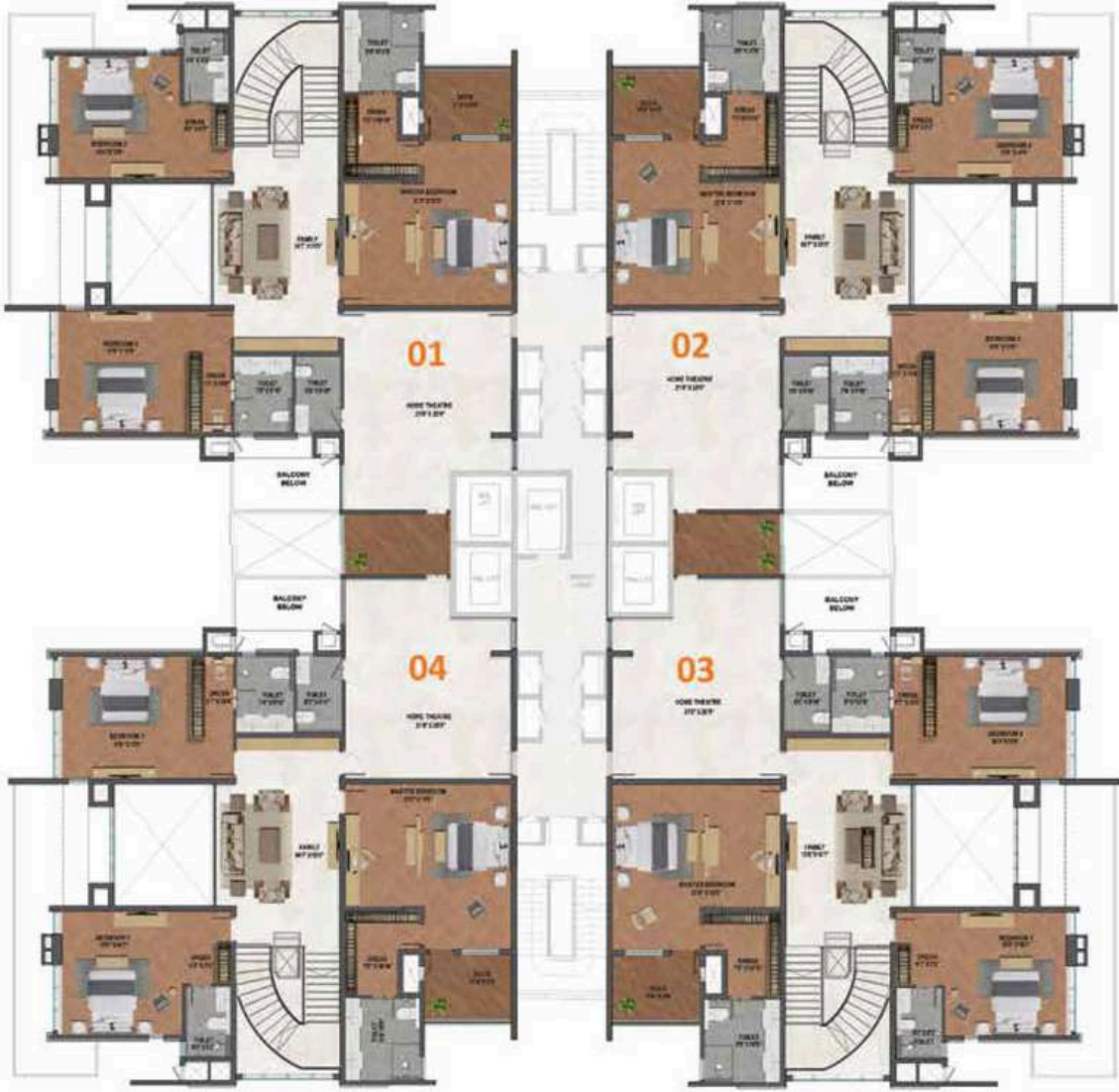

KEY PLAN

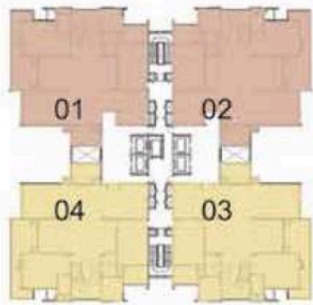

CLUSTER PLAN
TOWER-03

UNIT TYPE - A - SKY VILLAS

Tower - 03 - Level 02

UNIT TYPE - A	
	SFT
SALEABLE AREA	4044
CARPET AREA	2879
CARPET+BALCONY AREA	3161



KEY PLAN

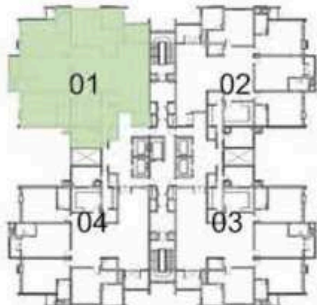

CLUSTER PLAN
TOWER-03

UNIT TYPE - A - SKY VILLAS

Tower - 03 - Level 02

UNIT TYPE - A	
	SFT
SALEABLE AREA	4044
CARPET AREA	2879
CARPET+BALCONY AREA	3161



KEY PLAN



CLUSTER PLAN
TOWER-03

UNIT TYPE - B1 - SKY VILLAS

Tower - 03 - Level 7, 9, 11, 13, 15, 17, 19, 21, 23, 25

UNIT TYPE - B1	
	SFT
SALEABLE AREA	4260
CARPET AREA	2928
CARPET+BALCONY AREA	3343



KEY PLAN



CLUSTER PLAN
TOWER-03

UNIT TYPE - B1 - SKY VILLAS

Tower - 03 - Level 7, 9, 11, 13, 15, 17, 19, 21, 23, 25

UNIT TYPE - B1	
	SFT
SALEABLE AREA	4260
CARPET AREA	2928
CARPET+BALCONY AREA	3343



KEY PLAN



CLUSTER PLAN
TOWER-03

UNIT TYPE - A2 - SKY VILLAS
(DUPLEX SKY VILLAS UNIT) - LOWER LEVEL PLAN

Tower - 03 - Level 26

UNIT TYPE - A2	
SALEABLE AREA	SFT
7737	
CARPET AREA	5393
CARPET+BALCONY AREA	6099



KEY PLAN



CLUSTER PLAN
TOWER-03

UNIT TYPE - A2 - SKY VILLAS
(DUPLEX SKY VILLAS UNIT) - UPPER LEVEL PLAN

Tower - 03 - Level 27



KEY PLAN

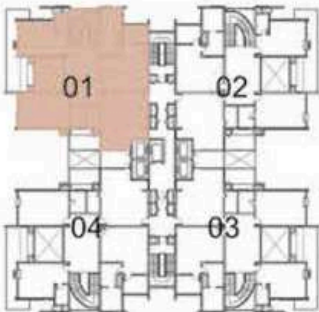

CLUSTER PLAN
TOWER-03

TOWER 3

Cluster Plan: Level 2

COLOUR	UNIT TYPE	NO.OF UNITS	SALEABLE AREA	CARPET+ BALCONY AREA
	A - SKY VILLAS	02	4044 SFT	3161 SFT
	B - SKY VILLAS	02	4094 SFT	3210 SFT



KEY PLAN

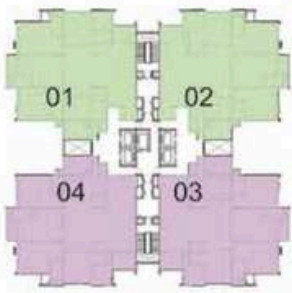

CLUSTER PLAN
TOWER-03

TOWER 3

Cluster Plan: Level 3-6, 8, 10, 12, 14, 16, 18, 20, 22, 24

COLOUR	UNIT TYPE	NO.OF UNITS	SALEABLE AREA	CARPET+ BALCONY AREA
	A - SKY VILLAS	26	4044 SFT	3161 SFT
	B - SKY VILLAS	26	4094 SFT	3210 SFT



KEY PLAN

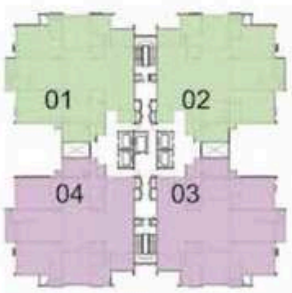

CLUSTER PLAN
TOWER-03

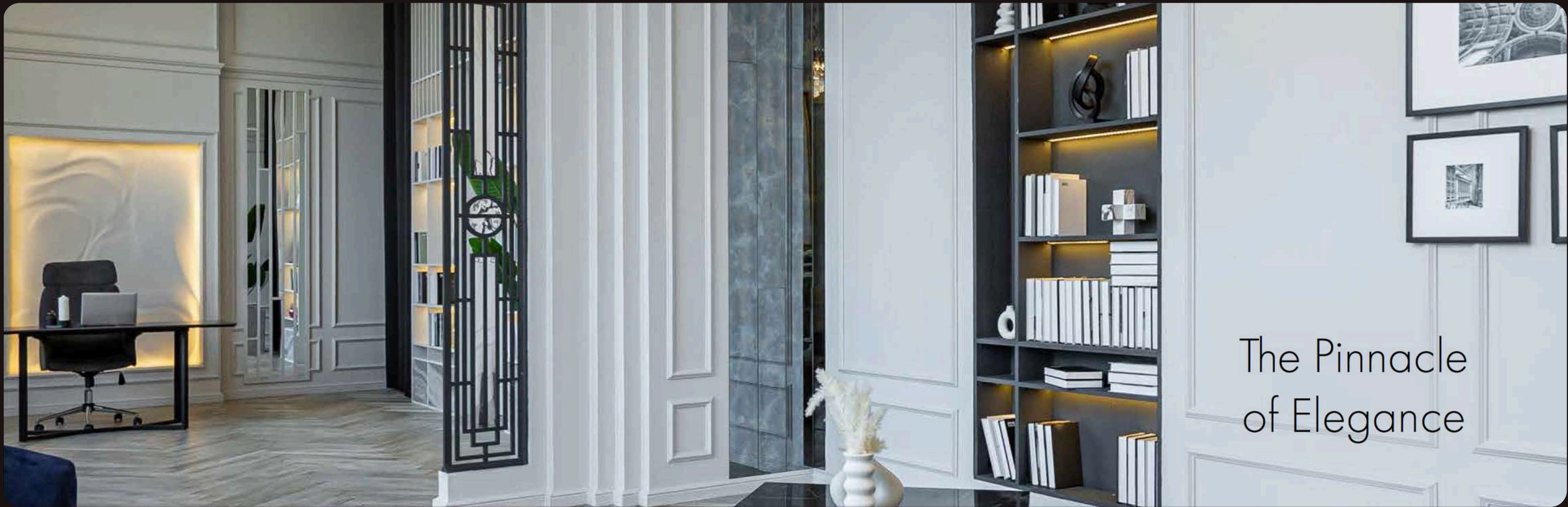

The Pinnacle
of Elegance



Temperature Controlled
Swimming Pool



Wellness Cafe



Party Lawn



Spa



Co-working Space



Indoor Games



Gymnasium



Guest Rooms

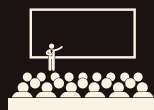

Multipurpose Room



Badminton Court



Banquet Hall

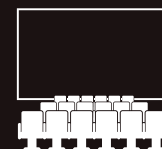

Movie Theater

Live Among the Elite



Cafeteria/Food Court

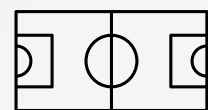

Basketball Court

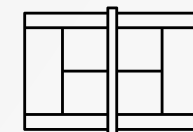

Outdoor Tennis Courts



Skydeck



Badminton Court

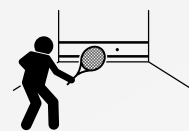

Squash Court



Tennis Court

20+

Other Outdoor
Amenities

Features

- Luxury residential community positioned on a gentle hillock
- Dual Living Options: Sky Villas and Independent Bungalows.
- Strategic Location in Whitefield.
- Luxurious Amenities and Facilities.
- Premium Interiors and Specifications.

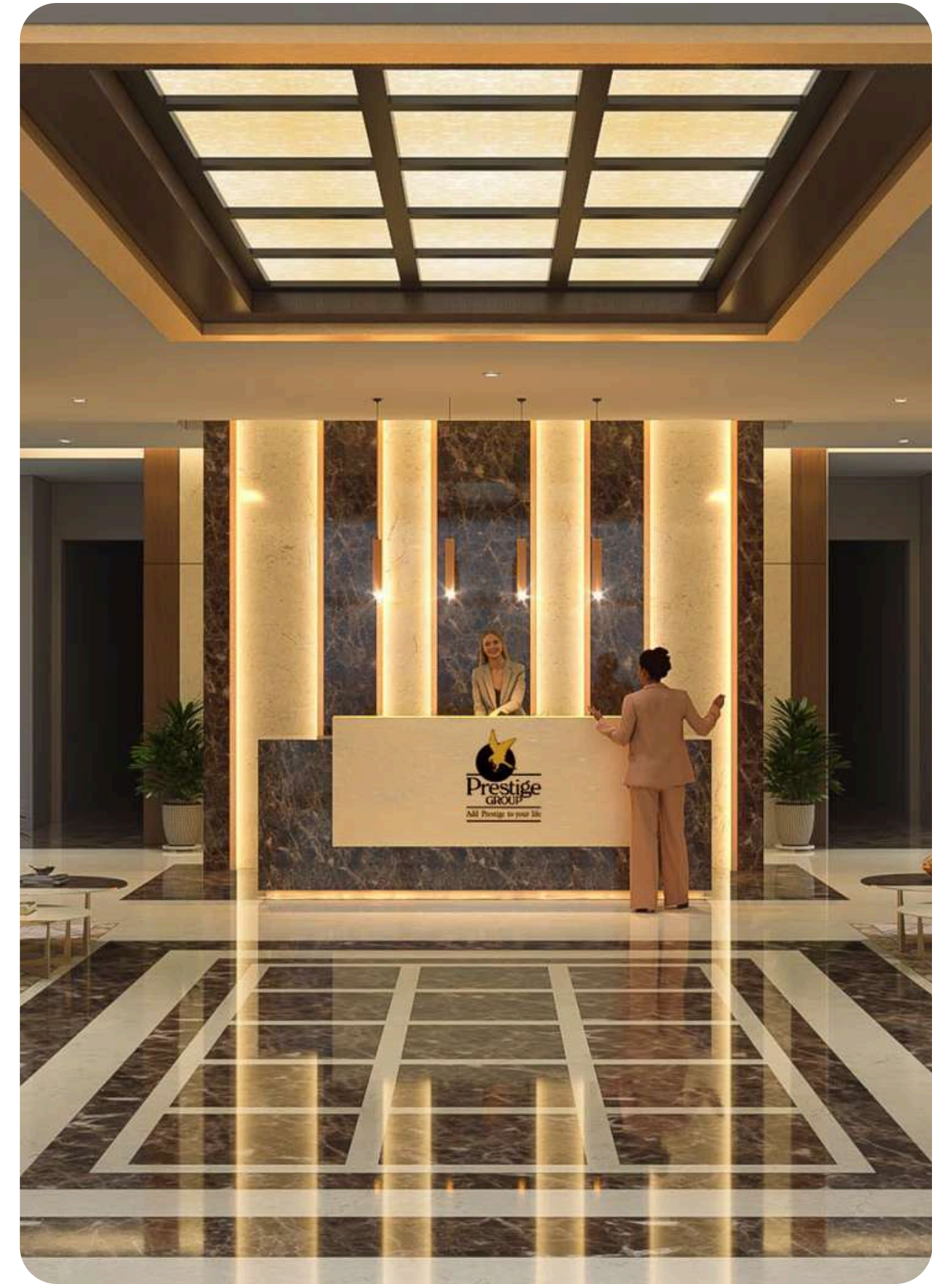

Why choose this project?

01

Ultra-Luxury Living

Prestige White Meadows is specifically designed for the luxury segment, offering opulent Sky Villas and Bungalows equipped with world-class finishes, fittings, and premium architectural design.

03

Dual Living Options

Buyers can choose between high-rise Sky Villas or sprawling Independent Bungalows, catering to different lifestyle preferences while maintaining the same level of luxury.

02

Prime Location – Whitefield

Located in one of Bangalore's most coveted and fast-developing neighborhoods, Whitefield, the project offers seamless connectivity to IT parks, international schools, hospitals, and top shopping destinations.

04

Excellent Appreciation Potential

Given its location, luxury status, and developer credibility, Prestige White Meadows has strong potential for property value appreciation and high-end rental demand.

About Lavish Living Homes

At Lavish Living Homes, we specialize in curating ultra-luxury residences for the discerning few. With a deep understanding of what luxury means, we handpick properties that embody sophistication, innovation, and exclusivity.

Our mission is to match you with a home that reflects your aspirations, offering personalized service every step of the way. We ensure every detail meets the highest standards. Trust us to deliver not just a house, but a legacy of lavish living.

At Lavish Living Homes, we understand that buying a luxury villa is not just a transaction; it's a significant life decision.

Our mission is to redefine the luxury home-buying experience by offering unparalleled service and comprehensive information about each property.



Have questions?

Reach out to us for any inquiries on given details.

17



Phone Number
+91 91234 66308

Email
info@lavishliving.homes

website
lavishliving.homes